



ax314DW

The NEW Versamill® AX314DW dental milling machine provides super versatility with its ability to mill virtually any dental material while providing the thinnest of margins without chipping.

The AX314DW is a desktop milling machine specialized for soft & hard materials. Small and compact, but fast and accurate. The extremely stable construction of the AX314DW enables the efficient dry-machining of dental restorations. Optimized to delicately mill with thin, clean margins, the prostheses that require sophisticated techniques such as facial, undercut, inlay, and veneer can be milled precisely—without chipping.

**SPEED**  
COLLECTION  
SERIES



### FLEXIBILITY TO MEET THE DEMANDS OF TODAY AND TOMORROW

Process a wide variety of dental material, including: PMMA, Zirconia, PEEK, Pekkton, Composites, Hybrid-Ceramic, Titanium Premill Abutments, Glass-Ceramic, and More.

98mm disc with up to 30mm thickness.

### INDICATIONS



Hybrid Bar    Screw-Retained Bridge    Custom Abutment    Hybrid Abutment



Crown & Coping    Bridge    Model    Bite Splint



Inlay & Onlay    Veneers

### AVAILABLE COLORS



Clinician Blue    Sage Wisdom    Charcoal

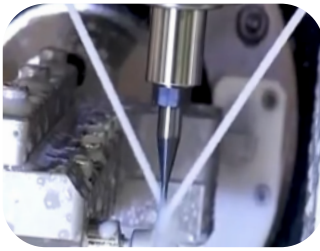

High-torque, 1.37kW max spindle with ceramic hybrid bearings that help to reduce margin thickness, and extend spindle life by reducing deflection and protecting against contamination by cutting chips and coolant.

## ax 314DW

Superior dynamic motion and positional accuracy thanks to large-diameter precision ball screws, anti-backlash ball nuts and linear guides with closed loop servo drives.

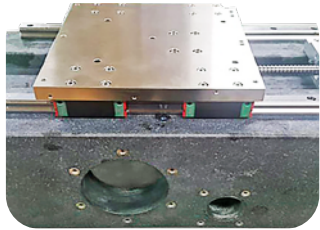
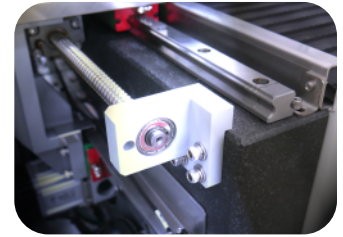

Heavy, stable, granite frame with the lowest coefficient of linear expansion. Provides the rigidity and precision to enable the production of highest possible restoration precision.

C-Clamp fixture provides unlimited access to critical facial features which produces the highest levels of aesthetics—without the concern of undercuts or typical manufacturing limitations.

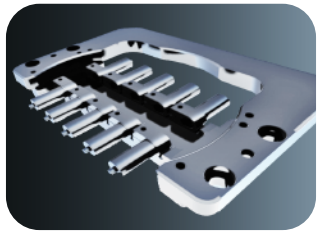

The ultimate in productivity, the AX314DW fixtures can facilitate the machining of 10 titanium premill abutments and 6 ceramic blocks.

Easy-to-Use. The Versamill 314DW's touch screen control features a large color touch screen that is easy to read and use in production.



16-station ATC houses 6.0 mm diameter cutting tools with automatic tool management and breakage sensor.

The strength and rigidity of the Versamill AX314DW enables the efficient processing of restorations while yielding the thinnest and cleanest of restorative margins.



Wet Milling Dry Milling Auto Calibration

## CAM SOFTWARE: PROVEN & FULL-FEATURED

The Versamill AX314DW is powered by your choice of GO2cam or hyperDENT CAM software from FOLLOW-ME! Technology Group.

These products are selected as they incorporate efficient proven milling cycles from the industrial segment to provide maximum process stability and indication quality, including patent-protected milling strategies used for complex materials ensuring perfect surface quality while maximizing tool life.

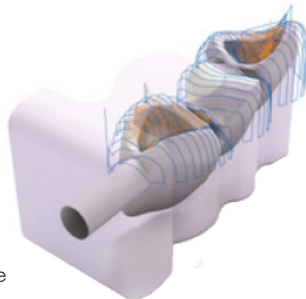

### hyperDENT

### GO2cam

#### OPTIONAL MODULES

Full Denture, Hybrid, Implant, Template Generator

Multi Import & Nesting, Implant Bar/Bridge, Expert, Expanded Import

All Versamill machines come with Axsys' award-winning support and unique software and machine enhancements not available from any other supplier. We leverage over 40 years of digital design and manufacturing experience—spanning a variety of industries—to provide additional functionality, unrivaled reliability and increased productivity.

## FIXTURES

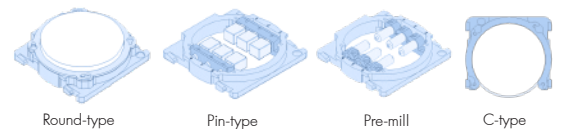

Round-type

Pin-type

Pre-mill

C-type

## Versamill AX314DW Specifications

Number of axes:		5 simultaneous
Travel (x, y, z axis):	(mm)	200 x 102 x 108
B Rotational axis:	(degrees)	±30°
Processing:		Wet/Dry
Drive Mechanism:		Ball screw
Way System:		Linear Guide
Air Requirement:		6.5 bar
Spindle Power:	(watts)	AC 1.37kW max
Spindle Speed:	(rpm)	80,000
ATC number of tools:	6.0mm Ø	16
Axis Drive System		Servo Motor w/Encoder
Blank disc diameter:	(mm)	98 Ø
Machine size (W x H x D):	(mm)	500 x 720 x 690
Weight:	(mm)	130Kg
Input Power	(VAC/50-60Hz)	120-240 /6A Single Phase